

Isle Of Wight
Sales And Lettings Ltd



01983 642122
Info@iowsl.co.uk



Lets Get You Moving



DANIEL PARR
exp
Sales & Lettings
01983 642122
FOR SALE

PER MONTH
£1,400 Per month
Charnwood Close
Newport, PO30 5ZQ

EPC RATING: C COUNCIL TAX BAND: C

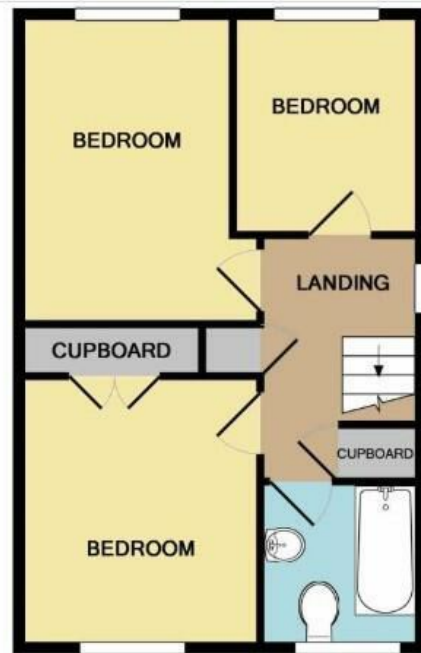
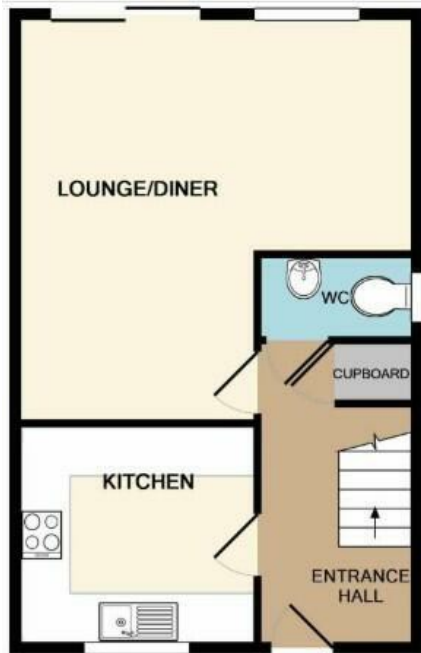

Energy Efficiency Rating		Current	Potential
Very energy efficient - lower running costs			
(92 plus) A			
(81-91) B			
(69-80) C			
(55-68) D			
(39-54) E			
(21-38) F			
(1-20) G			
Not energy efficient - higher running costs			
England & Wales		EU Directive 2002/91/EC	

Agents Note: Whilst every care has been taken to prepare these particulars, they are for guidance purposes only. All measurements are approximate and are for general guidance purposes only and whilst every care has been taken to ensure their accuracy, they should not be relied upon and potential buyers/tenants are advised to recheck the measurements

Isle Of Wight
Sales And Lettings Ltd

01983 642122
info@iowsl.co.uk

Lets Get You Moving

OFFICE ADDRESS
Flat 7 Auckland Court, 11
Auckland Road East
Southsea
PO5 2HA

OFFICE DETAILS
01983 642122
info@iowsl.co.uk